

880nm 1mw~2mw SM Coaxial Pigtailed Laser Diode with SMF28 9um Fiber

870nm~880nm SM Fiber Coupled LD with Single Mode Fiber

WSLP-880-002m-9-PD

Wavespectrum Laser Group

www.wavespectrum-laser.com

| 880nm Pigtailed Diode Laser | | 1mW/SM Fiber | | Wavespectrum Laser Group | |
|---|--|--------------|--------|--------------------------|--|
| PARAMETER | SYMBOL | VALUE | UNIT | | |
| Reverse Voltage | V_r | 2.0 | V | | |
| Operating Temperature | T_{op} | -10~+60 | °C | | |
| Storage Temperature | T_{stg} | -20 ~ +85 | °C | | |
| Lead soldering temperature (5 sec.) | T_{is} | 250 | °C | | |
| Features: <ul style="list-style-type: none"> • 880nm • 9um Fiber • Coaxial package • Built-in PD |  | | | | |
| Applications: <ul style="list-style-type: none"> • Medical laser treatment • Sensor • Others | | | | | |
| Specifications | WSLP-880-002m-9-PD | | | | |
| | Min | Type | Max | | |
| Center Wavelength@25°C | 870nm | 880nm | 890nm | | |
| Recommend Operating Temperature | 25°C | | | | |
| Output Power | 1.5mw | 2mw | ---- | | |
| Fiber Type | SMF28 | | | | |
| Fiber Core | 9um | | | | |
| Monitor Current | ---- | 0.25mA | 0.55mA | | |
| PD Reverse Voltage | ---- | 30V | ---- | | |
| Fiber Connector | FC | | | | |
| Fiber Length | ---- | 80cm | 100cm | | |
| Threshold Current (Typ.) | ---- | 10mA | 18mA | | |
| Operating Current (Typ.) | ---- | 30mA | 35mA | | |
| Operating Voltage | ---- | 2.2V | 2.4V | | |
| Package Style | Coaxial | | | | |
| Photodiodes | Built-in | | | | |



Coaxial Package View

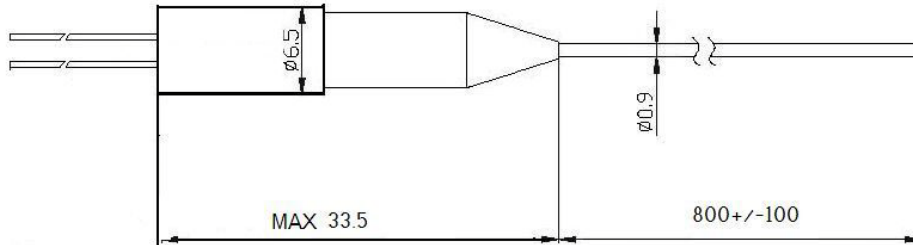

PIN Bottom View:

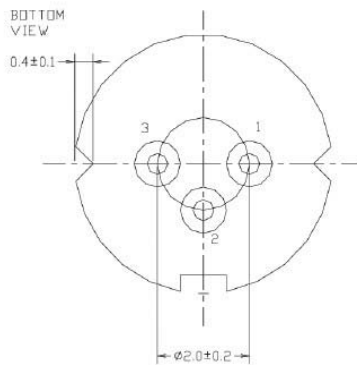

| | |
|----------|------------------------|
| 1 | LD(-) |
| 2 | LD(+)&PD(-) |
| 3 | PD(+) |

Electrically shorten LD module and store in non-extreme conditions.
Suggest using the constant current power supply.



Wavespectrum Laser, Inc.
www.wavespectrum-laser.com
wavespectrumlaser@gmail.com

