

976nm~980nm 2W LD with TO 3 Can

980nm 2w high power laser diodes

WSLD-980-002-3 Wavespectrum laser inc.

www.wavespectrum-laser.com

980nm Laser Diode		2W	Wavespectrum Laser, Inc	
Reverse Voltage	V_r	2.0	V	
Operating Temperature	T_{op}	10~+30	°C	
Storage Temperature	T_{stg}	-40 ~ +85	°C	
Lead soldering temperature (10 sec.)	T_{is}	260	°C	
Features: <ul style="list-style-type: none"> ● 980nm ● CW ● TO3 package 				
Applications: <ul style="list-style-type: none"> ● Medical laser treatment ● Laser indicator ● Laser detector 				
Specifications		WSLD-980-002-3		
		Min	Type	Max
Center Wavelength@25°C		970nm	980nm	990nm
Spectral Width (FWHM)		----	----	2.5nm
Output Power		----	2W	----
Emitter Area		----	150x1µm	----
Beam Divergence (FWHM)		----	----	$42^{\circ} \pm 10^{\circ} //$
Temperature Coefficient of Wavelength		----	0.3nm / °C	----
Slope Efficiency		----	1.0mW/mA	----
Threshold Current (Typ.)		----	----	500mA
Operating Current (Typ.)		----	----	2.56A
Operating Voltage		----	----	2.0V
Package Style	TO3			



T03 Package View

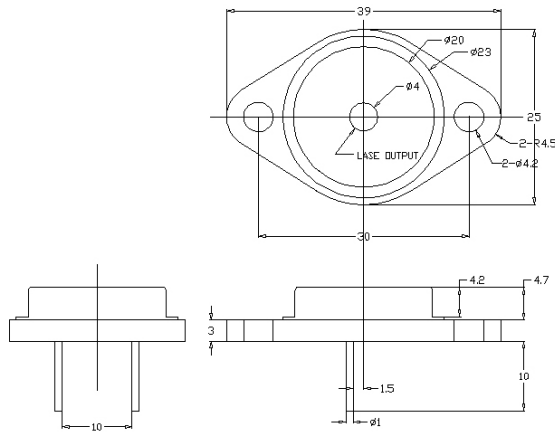

**Electrically shorten LD module and store in non-extreme conditions.
Suggest using the constant current power supply.**



Please contact us:

Website: www.wavespectrum-laser.com (for more detailed information)

Email: info@wavespectrum-laser.com (for inquiry about this product)

