

650nm~660nm 80mW~100mW Fiber Coupled Laser Diode with SMF-28 Fiber

650nm 100mW Coaxial Pigtailed LD with 9um Fiber | High Power SM Red Diode Laser Module

WSLP-650-100m-9

Wavespectrum Laser Group

www.wavespectrum-laser.com

650nm Pigtailed Diode Laser		Wavespectrum Laser Group	
PARAMETER	SYMBOL	VALUE	UNIT
Reverse Voltage	V_r	2.0	V
Operating Temperature	T_{op}	-10~+50	°C
Storage Temperature	T_{stg}	-40~+85	°C
Lead soldering temperature (10 sec.)	T_{is}	260	°C
Features: <ul style="list-style-type: none"> ● 650nm ● With 9um Fiber ● Coaxial Package 			
Applications: <ul style="list-style-type: none"> ● Medical Laser Treatment ● Other 			
Specifications	WSLP-650-100m-9		
	Min	Type	Max
Center Wavelength@25°C	650nm	658nm	665nm
Spectral Width (FWHM)	----	2.0nm	----
Output Power	80mW	-----	100mW
Fiber Type	SMF-28		
Fiber Core	9um		
Recommend Operating Temperature	25°C		
Fiber Connector	FC/SC/SMA905		
Fiber Length	----	80cm	100cm
Threshold Current (Typ.)	----	55mA	75mA
Operating Current (Typ.)	----	260mA	280mA
Operating Voltage	----	2.7V	3.0V
Package Style	Coaxial		



Coaxial Package View

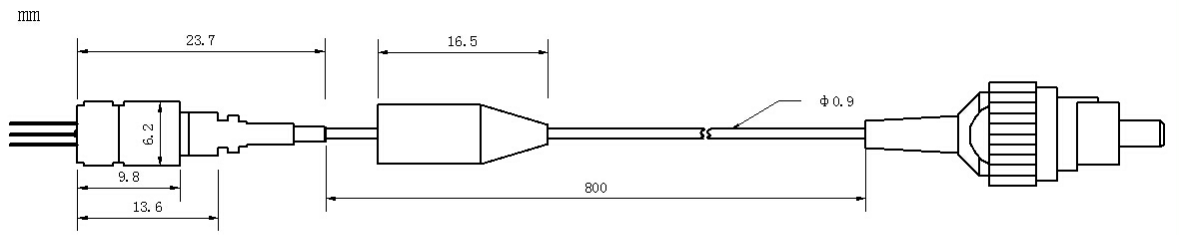

PIN Bottom View:

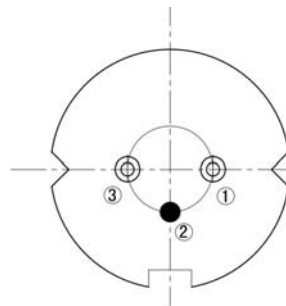

1	LD(+)
2	LD(-)
3	NC

Electrically shorten LD module and store in non-extreme conditions.
 Suggest using the constant current power supply.

