



870nm 3W High Power LD with TO Package

870nm~880nm Laser Diode | 3W Power| TO3 Can

WSLD-880-003-3

Wavespectrum Laser, Inc.

www.wavespectrum-laser.com

880nm Laser Diode 3W		Wavespectrum Laser, Inc	
PARAMETER	SYMBOL	VALUE	UNIT
Reverse Voltage	V_r	2.0	V
Operating Temperature	T_{op}	+15~+35	°C
Storage Temperature	T_{stg}	-40 ~ +60	°C
Lead soldering temperature (10 sec.)	T_{is}	260	°C
Features: <ul style="list-style-type: none"> 880nm Multimode TO3 package 			
Applications: <ul style="list-style-type: none"> Medical laser treatment Laser indicator Laser detector 			
Specifications		WSLD-880-003-3	
	Min	Type	Max
Center Wavelength@25°C	----	880nm +/-10nm	----
Spectral Width (FWHM)		2.0nm	
Output Power	----	3W	----
Emitter Area	----	150x1µm	----
Beam Divergence (FWHM)	----	70° _⊥ x 10° _{//}	----
Temperature Coefficient of Wavelength	----	0.28nm / °C	----
Slope Efficiency	0.9W/A	1.1W/A	1.2W/A
Threshold Current (Typ.)	----	0.7A	----
Operating Current (Typ.)	----	3A	3.4A
Operating Voltage	----	2.0V	----
Package Style	TO3		



T03 Package View

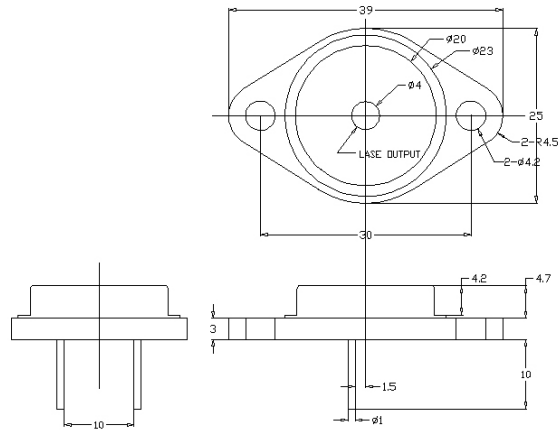

**Electrically shorten LD module and store in non-extreme conditions.
Suggest using the constant current power supply.**

