

**940nm 30mw SM Coaxial Pigtailed Laser Diode with PMF**

**940nm SM Fiber Coupled LD with Polarization Fiber (PM Fiber)**

**WSLP-940-030m-PM-PD**

**Wavespectrum Laser Group**

**www.wavespectrum-laser.com**

940nm Pigtailed Diode Laser		30mW/PM Fiber		Wavespectrum Laser, Inc	
PARAMETER	SYMBOL	VALUE		UNIT	
Reverse Voltage	$V_r$	2.0		V	
Operating Temperature	$T_{op}$	-20 ~ +50		°C	
Storage Temperature	$T_{stg}$	-40 ~ +85		°C	
Lead soldering temperature (5 sec.)	$T_{is}$	250		°C	
<b>Features:</b> <ul style="list-style-type: none"> <li>• 940nm</li> <li>• PM Fiber</li> <li>• Coaxial package</li> <li>• Built-in PD</li> </ul>					
<b>Applications:</b> <ul style="list-style-type: none"> <li>• Medical laser treatment</li> <li>• Sensor</li> <li>• Others</li> </ul>					
<b>Specifications</b>		<b>WSLP-940-030m-PM-PD</b>			
		Min	Type	Max	
Center Wavelength@25°C		930nm	940nm	950nm	
Recommend Operating Temperature		25°C			
Output Power		----	30mw	----	
Fiber Type		PM Fiber			
Fiber Core		5um			
Monitor Current		----	0.2mA	0.6mA	
PD Reverse Voltage		----	30V	----	
Fiber Connector		FC			
Fiber Length		----	80cm	100cm	
Threshold Current (Typ.)		----	20mA	40mA	
Operating Current (Typ.)		----	150mA	180mA	
Operating Voltage		----	1.9V	2.3V	
Package Style		Coaxial			
Photodiodes		Built-in			



### Coaxial Package View

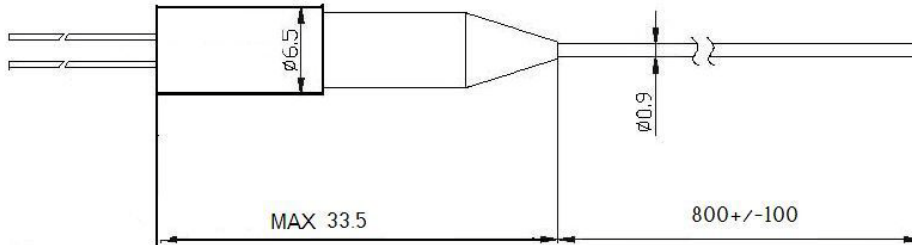

### PIN Bottom View:

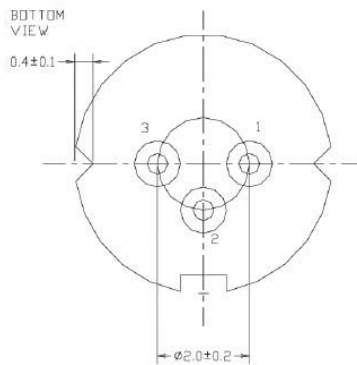

<b>1</b>	<b>LD(-)</b>
<b>2</b>	<b>LD(+)&amp;PD(-)</b>
<b>3</b>	<b>PD(+)</b>

Electrically shorten LD module and store in non-extreme conditions.  
Suggest using the constant current power supply.

