

785nm 50mw~60mw SM Pigtailed Laser diode with PMF

780nm~785nm SM Fiber Coupled LD With Polarization Maintaining Fiber (PM Fiber)

WSLP-785-060m-PM-PD

Wavespectrum Laser Group

www.wavespectrum-laser.com

785nm Pigtailed Diode Laser		60mW/PM Fiber		Wavespectrum Laser, Inc	
PARAMETER	SYMBOL	VALUE		UNIT	
Reverse Voltage	V_r	2.0		V	
Operating Temperature	T_{op}	-10~+60		°C	
Storage Temperature	T_{stg}	-40 ~ +85		°C	
Lead soldering temperature (10 sec.)	T_{is}	260		°C	
Features: <ul style="list-style-type: none"> • 785nm • PM Fiber • Coaxial package • Built-in PD 					
Applications: <ul style="list-style-type: none"> • Medical laser treatment • Others 					
Specifications		WSLP-785-060m-PM-PD			
		Min	Type	Max	
Center Wavelength@25°C		775nm	785nm	795nm	
Recommend Operating Temperature		25°C			
Output Power		50mw	60mw	----	
Fiber Type		PM Fiber			
Fiber Core		4um			
Monitor Current		----	0.2mA	0.5mA	
PD Reverse Voltage		----	30V	----	
Fiber Connector		FC			
Fiber Length		----	80cm	100cm	
Threshold Current (Typ.)		----	30mA	50mA	
Operating Current (Typ.)		----	140mA	160mA	
Operating Voltage		----	2.0V	2.4V	
Package Style		Coaxial			
PD		Built-in			



Coaxial Package View

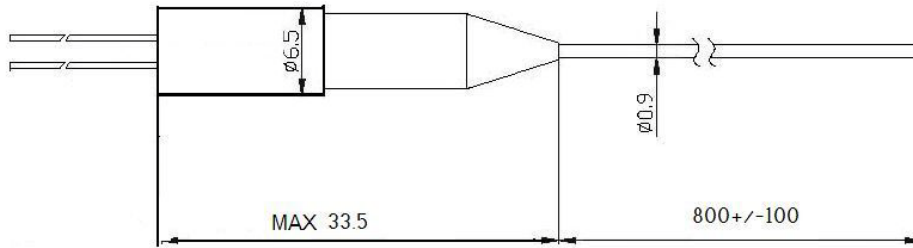

PIN Bottom View:

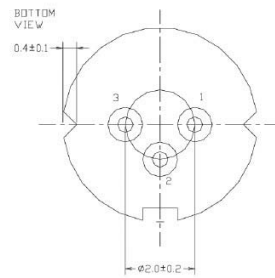

1	LD(+)
2	LD(-)&PD(+)
3	PD(-)

OR

1	LD(-)
2	LD(+)&PD(-)
3	PD(+)

Electrically shorten LD module and store in non-extreme conditions.
Suggest using the constant current power supply.



Wavespectrum Laser, Inc.
www.wavespectrum-laser.com
wavespectrumlaser@gmail.com

