

635nm~638nm 15mW~20mW SM Fiber Coupled Diode Laser with Coaxial Package | Red LD
635nm 15mW Pigtailed Laser Diode with 4um Single Mode Fiber (SMF) | Built-in PD
WSLP-635-015m-4-PD **Wavespectrum Laser Group** **www.wavespectrum-laser.com**

635nm Pigtailed Diode Laser		Wavespectrum Laser Group	
PARAMETER	SYMBOL	VALUE	UNIT
Reverse Voltage	V_r	2.0	V
Operating Temperature	T_{op}	-10~+50	°C
Storage Temperature	T_{stg}	-40~+85	°C
Lead soldering temperature (10 sec.)	T_{is}	260	°C
Features: <ul style="list-style-type: none"> ● 635nm ● 4um SM Fiber ● Coaxial Package ● Built-in PD 			
Applications: <ul style="list-style-type: none"> ● Medical Laser Treatment ● Aiming Beam ● Others 			
Specifications	WSLP-635-015m-4-PD		
	Min	Type	Max
Center Wavelength@25°C	630nm	638nm	645nm
Recommended work Temperature	25°C		
Output Power	----	15mW	----
Fiber Type	Single Mode Fiber		
Fiber Core	4um		
Monitor Current	----	0.5mA	----
PD Reverse Voltage	----	30V	----
Fiber Connector	FC/SC/SMA905		
Fiber Length	----	80cm	100cm
Threshold Current (Typ.)	----	45mA	65mA
Operating Current (Typ.)	----	100mA	120mA
Operating Voltage	----	2.5V	3.0V
Package Style	Coaxial		
PD	Built-in		

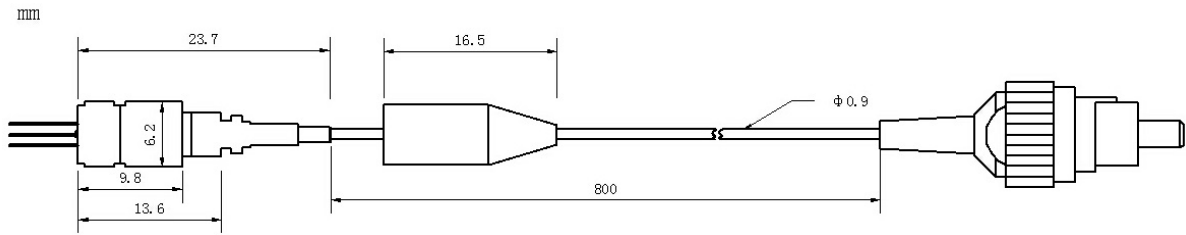

Coaxial Package View



PIN Bottom View:

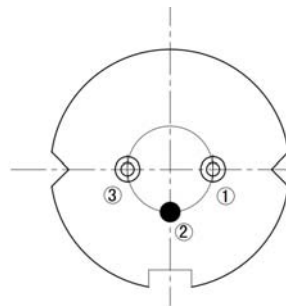

1	LD(-)
2	LD(+)&PD(-)
3	PD(+)

Electrically shorten LD module and store in non-extreme conditions.
 Suggest using the constant current power supply.

