

**792nm~793nm 2W~2.5W Fiber Coupled Diode Laser Module**
**792nm|4-pin Package| 105um 200um 400um Fiber Core| High Power LD | PD Optional**
**WSLX-792-002-H**
**Wavespectrum Laser Group**
**www.wavespectrum-laser.com**

PARAMETER	SYMBOL	VALUE	UNIT
Reverse Voltage	$V_r$	2.0	V
Operating Temperature	$T_{op}$	+15 ~ +35	°C
Storage Temperature	$T_{stg}$	-40 ~ +60	°C
Lead soldering temperature (10 sec.)	$T_{is}$	260	°C

**Features:**

- 792nm
- 4-pin Package
- PD Optional

**Applications:**

- Medical laser treatment
- Pumping
- Others

**Specifications**
**WSLX-792-002-H**

	Min	Type	Max
Center Wavelength@25°C	----	792±5nm	----
Spectral Width (FWHM)	----	----	2nm
Output Power	2W	2.2W	----
Temperature Coefficient of Wavelength	0.28nm / °C		
Threshold Current (Typ.)	700mA		
Operating Current (Typ.)	3.4A		
Operating Voltage	2V		
Recommended Case Temperature	25°C		
TEC Max. Current	----		
TEC Max. Voltage	----		
Fiber Core Diameter	200um (105um 400um Optional)		
Fiber Numerical Aperture	0.22		
Fiber Length	100cm		
Connector Type	SMA905/ST/FC		
Package Style	4-pin		



#### 4-pin Package View

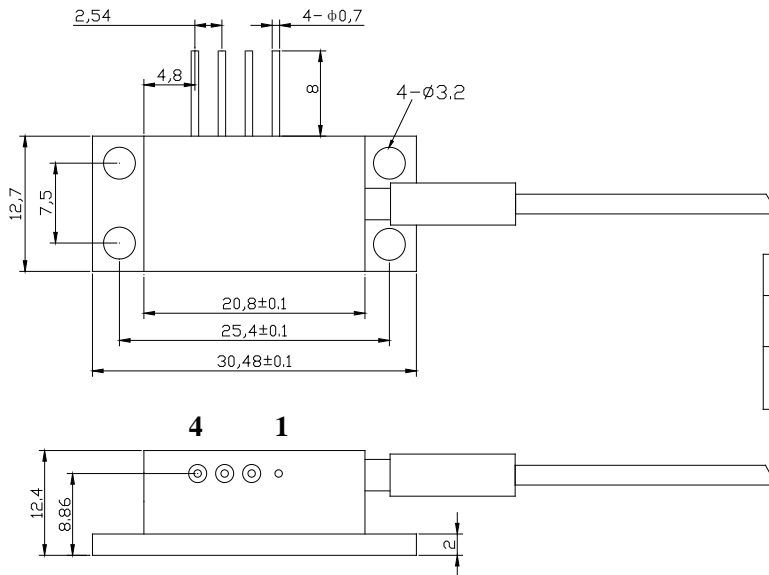

PIN	FUNCTION
1	LD (+)
2	LD (-)

Wavespectrum offer **Customized 792nm Fiber Coupled LD.**

- Customized Output Power
- Customized Fiber Core
- Dual-Wavelength or Tri-Wavelength Module Optional (such as 6w@792nm+350mw@635nm)

Contact us with [info@wavespectrum-laser.com](mailto:info@wavespectrum-laser.com)

Electrically shorten LD module and store in non-extreme conditions.

Suggest using the constant current power supply.



Wavespectrum Laser, Inc.  
[www.wavespectrum-laser.com](http://www.wavespectrum-laser.com)  
[wavespectrumlaser@gmail.com](mailto:wavespectrumlaser@gmail.com)

